



-

-

:

,

,

,

-

Abstract

Comparison of parameters of seismic reaction and stressed-deformed state of buildings with symmetric and asymmetric arrangement of bearing structures in the plan is compared. The importance of taking into account this factor for providing seismic stability of multistorey buildings with possible seismic influences is shown.

Keywords: seismic impact, multi-storey buildings, plan irregularity, stress-strain state

[1]

[2]

:

[1, 2]

-

,

()

(. 1).

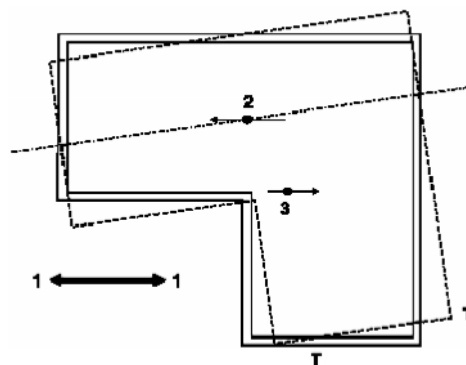

1 -

3 - ; 2 -

:

;

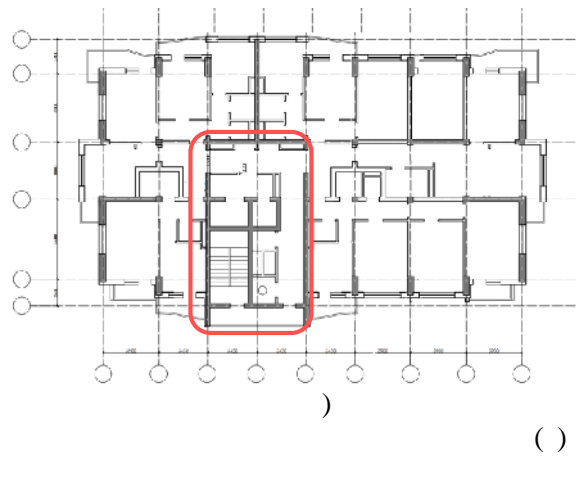
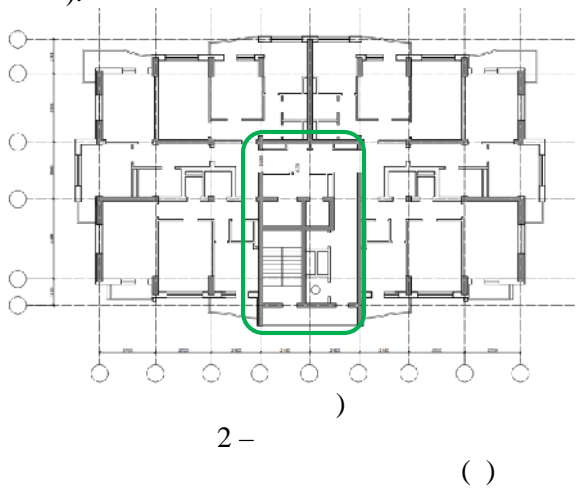

1. .1.1-12:2014. . – .: . 2014 . – 117 .
2. Eurocode 8: Design of Structures for Earthquake Resistance. Part 1: General Rules, Seismic Actions and Rules for Buildings”. EN 1998-1.

– , e-mail: vmandruchov@gmail.com; -17 , ;

Andruchov Valery Mikhailovich – PhD, Associate Professor, Vinnytsia National Technical University, e-mail: vmandruchov@gmail.com;
Meeschenko Andrey V. — student, Department of Building Heating and Gas Supply, Vinnytsia National Technical University, Vinnytsia city.